

\$12 - Suite C, 2411 4 Street Nw, Calgary

MLS® #A2055460

\$12

0 Bedroom, 0.00 Bathroom,
Commercial on 0.00 Acres

Mount Pleasant, Calgary, Alberta

Approximately 4,300 SF second floor office in centrally located northwest neighbourhood; located at Mount Pleasant. Multiple configurations available from 4,375 SF to 20,835 SF. Ample of free surface parking on site. Balcony access available for the front suites. Prominent signage exposure to 4th Street SE. Elevator and stair access to second floor. Commercial restaurant & bar on main floor. Also, child education facility on main floor. Walking distance to caf  s/restaurants, sport complexes, and parks. Public transportation available on 4th Street NW, including bus routes #2 and #404. Close proximity to 16 Avenue NE and Centre Street. 5 minutes to Downtown Calgary, and 5 minutes to Deerfoot Trail SE via 16 Avenue NE.

Built in 1966

Essential Information

| | |
|------------|------------|
| MLS® # | A2055460 |
| Price | \$12 |
| Bathrooms | 0.00 |
| Acres | 0.00 |
| Year Built | 1966 |
| Type | Commercial |
| Sub-Type | Office |
| Status | Active |

Community Information

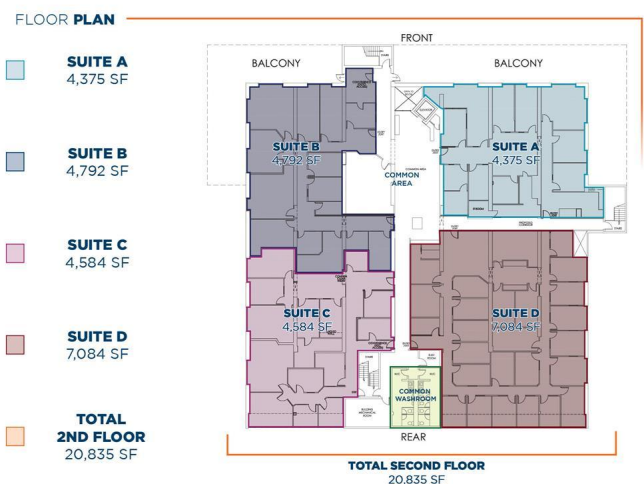

| | |
|-------------|---------------------------|
| Address | Suite C, 2411 4 Street Nw |
| Subdivision | Mount Pleasant |
| City | Calgary |
| County | Calgary |
| Province | Alberta |
| Postal Code | T2M 2Z8 |

Additional Information

| | |
|----------------|----------------|
| Date Listed | June 6th, 2023 |
| Days on Market | 825 |

Listing Details

| | |
|----------------|--------------------------|
| Listing Office | CDN Global Advisors Ltd. |
|----------------|--------------------------|

Data is supplied by Pillar 9â„¢ MLS® System. Pillar 9â„¢ is the owner of the copyright in its MLS® System. Data is deemed reliable but is not guaranteed accurate by Pillar 9â„¢. The trademarks MLS®, Multiple Listing Service® and the associated logos are owned by The Canadian Real Estate Association (CREA) and identify the quality of services provided by real estate professionals who are members of CREA. Used under license.